

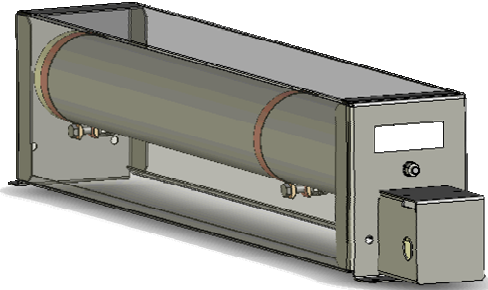

Series:
EFm – Tube Resistor unit 300W up to 670W
With terminal box

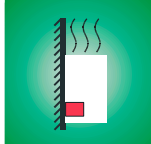
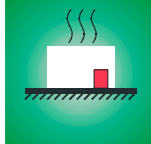

Applications:
As braking and chopper resistors
In variable-speed drives
In lifts and conveyors
In the printing and paper industries
In the packing, plastics and textile industries and
in machine construction
In the wire and wood processing industries

Types		EFm 60x300	EFm6	EFm7	EFm8
Pulse power in W T _a =25°C	c.d.f. 6%*	2850	3990	5225	6365
	c.d.f. 15%*	1470	2058	2695	3283
	c.d.f. 25%*	960	1344	1760	2144
	c.d.f. 40%*	660	924	1210	1474
	c.d.f. 60%*	450	630	825	1005
Continous rating in W T _a =25°C		300	420	550	670
Resistance values		0.47 - 3600Ω	0.68 - 5060Ω	0.86 - 6550Ω	1.1 - 8000Ω
Tolerance of resistance		± 10%			
Connection		M5 screw connection max. 25 A			
Degree of protection (DIN EN 60529)		IP 20 in according to screwed on condition			
Housing temperature at nominal rating T _a = 25°C		≤ 250 °C			
Cooling		Natural convection			
Storage temperature		-25 ... +85 °C			
Test voltage		2,5 kV AC			
Max. permissible operating voltage		800 V			
Approvals		UL possible			
Mounting positions					

* bezogen auf eine Zyklusdauer von 120 s

Series:
EFm – Tube Resistors unit 300W up to 670W
With terminal box

Constructions:

Drawing:



Dimensions:

Types	average weight in kg	width b1≤ in mm	width b2 in mm	high1≤ in mm	length l1≤ in mm	length l2 in mm
EFm 60x300	2.5	93	64	121	350	326
EFm 6	3.5	93	64	121	450	426
EFm 7	4.5	93	64	121	550	526
EFm 8	5.5	93	64	121	650	626

